

LUXE LENS

PRESET INSTALL & USE GUIDE ANDROID

This guide will walk you through the download, installation, & use of your new Luxe presets!

THELUXELEN.S.COM

CONTENTS

1
INSTALLATION

2
USE YOUR PRESETS

3
TROUBLESHOOTING

NEW TO PRESETS?

Welcome to our Android mobile guide for installing & using your new Luxe Lens presets! This is a quick process, but broken down into bite-sized steps!

Prefer a video guide? We've got one [HERE!](#)

To begin, be sure that:

- Your phone is up-to-date
- The [Lightroom app](#) is installed
- The [Lightroom app](#) is up-to-date
- You can locate your Download Email with a link that looks like this:

The Luxe Lens

Download Your Presets

Thank you

Use the link above to access your content.

Already tried to download your files and clicked too many times or cannot locate your download? Reach out to our team at support@theluxelens.com for 1:1 Support.

1

INSTALLATION

1 COPY YOUR LINK

You will receive a "Download Your Presets" link via email.

Press & hold that link until you see the option to "Copy URL"

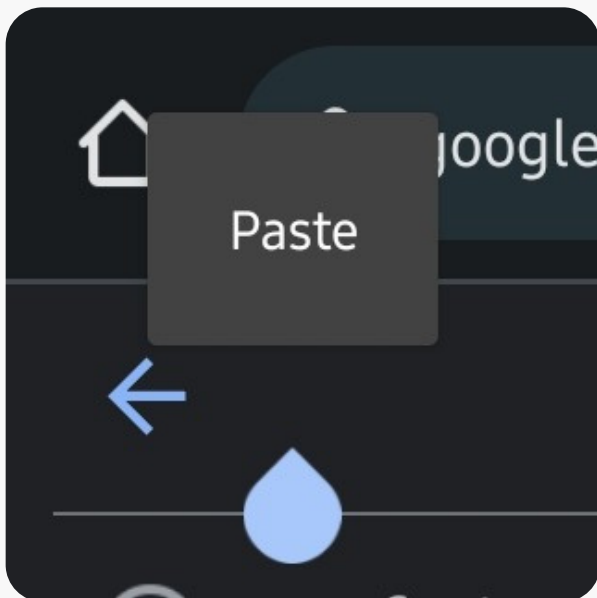
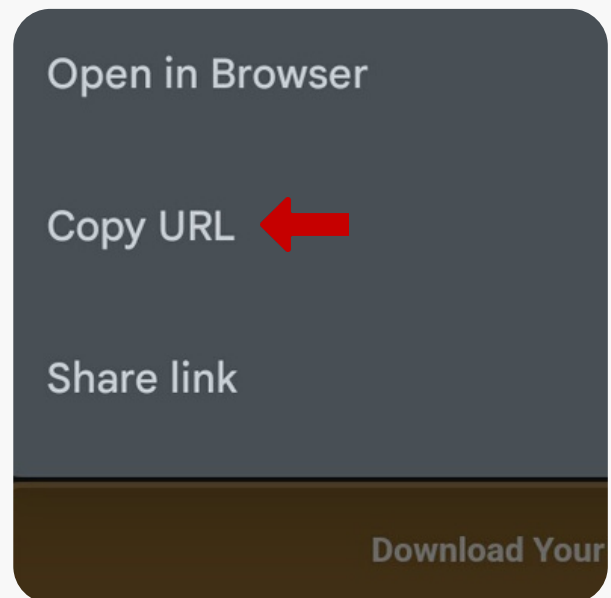

2 PASTE YOUR LINK

Launch the Chrome browser app.

Press & hold the URL bar until you see the option to "Paste" then press "Go" on your keyboard to navigate to your downloads page

3 SELECT XMP LINK

Select the XMP option!

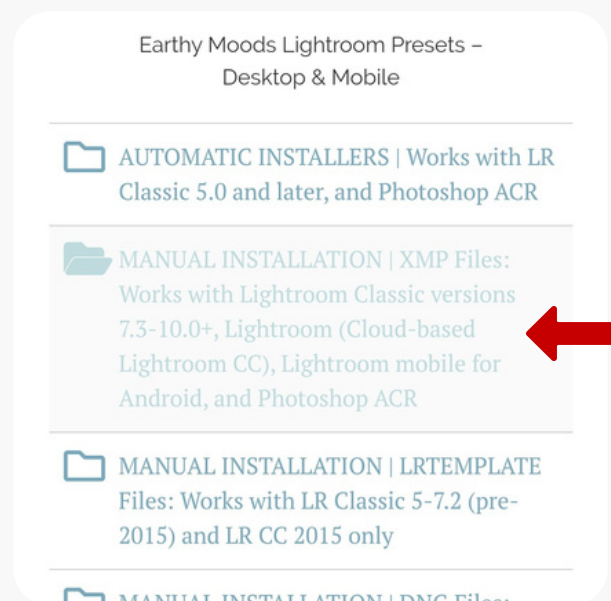

4 DOWNLOAD

Click to Download your XMP files.

IMPORTANT: Do NOT click on the pop-ups or on the finished downloads from your notifications!!

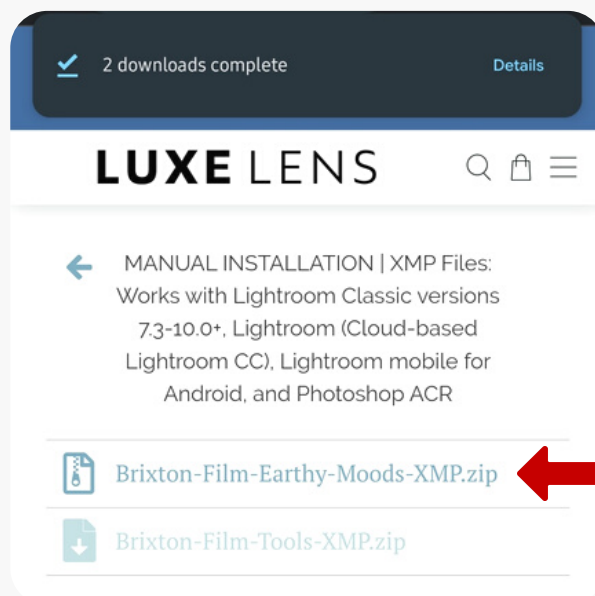

5 OPEN LIGHTROOM

Do NOT try to open your downloads or unzip them.

Simply launch the Lightroom mobile app.

Navigate to "Lightroom" on the bottom to view imported images.

6 SELECT AN IMAGE

Open any of your images into "Edit Mode" in Lightroom by clicking on it from your Lightroom library.

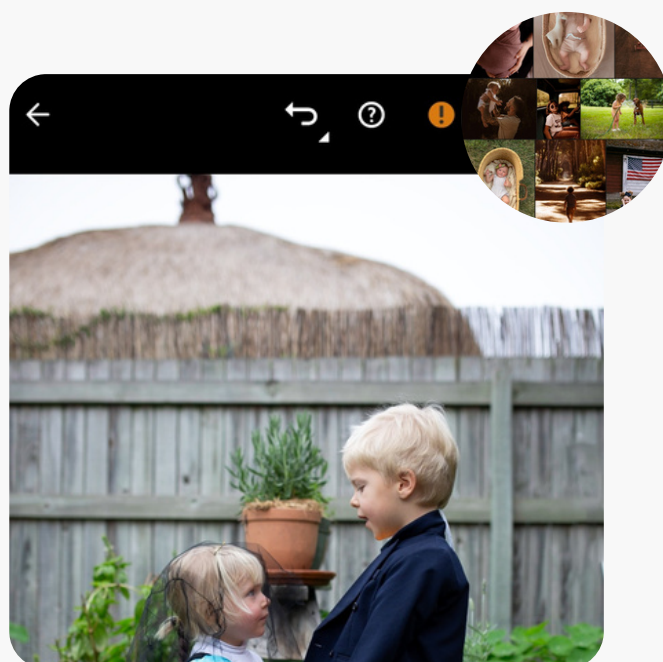

7

OPEN "PRESETS"

Select "Presets" from your bottom toolbar.

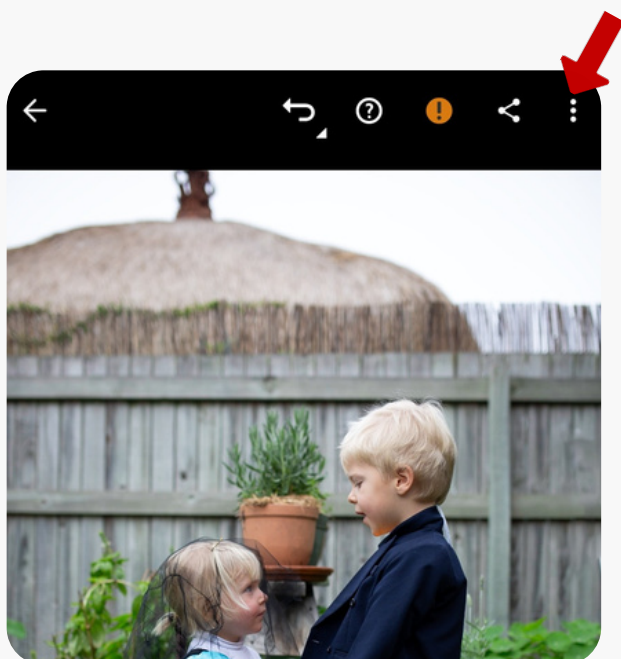
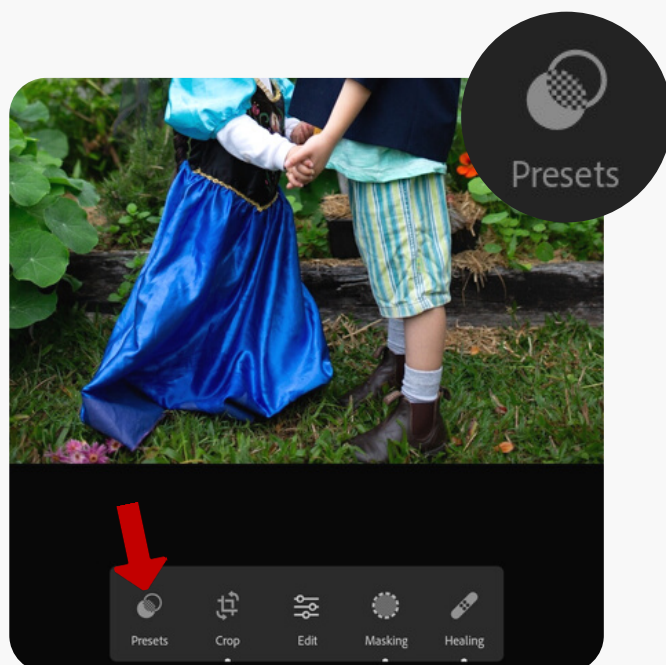

8

OPEN PRESETS MENU

Click the "..." menu on the top right to open the Presets menu.

9

SELECT "IMPORT PRESETS"

Select "Import Presets" from the menu that pops up from the bottom of your screen.

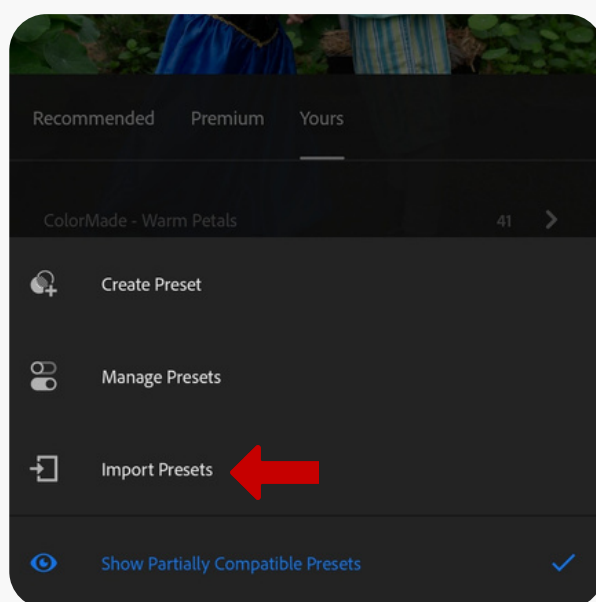

10

FIND DOWNLOAD

Locate your new download(s) for import

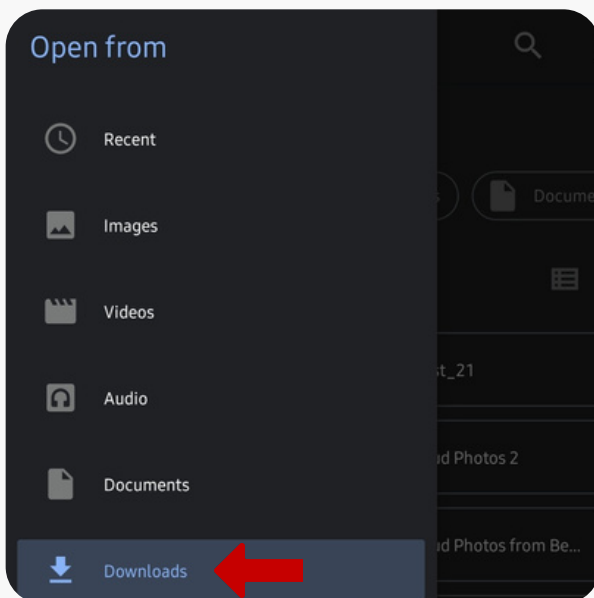

DON'T SEE THEM?

Make sure you are looking under "Downloads" and not another folder via the hamburger menu on the top left.

11

SELECT DOWNLOAD(S)

Press to select the XMP .zip file(s) you downloaded, then click "Select" on the top right to import.

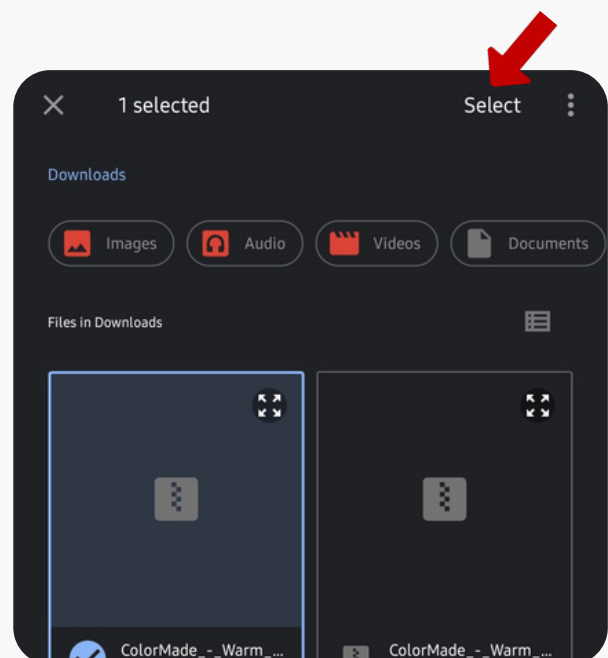

12

WAIT FOR IMPORT

If you downloaded & selected the correct files, you will see an import status message with a preset count.

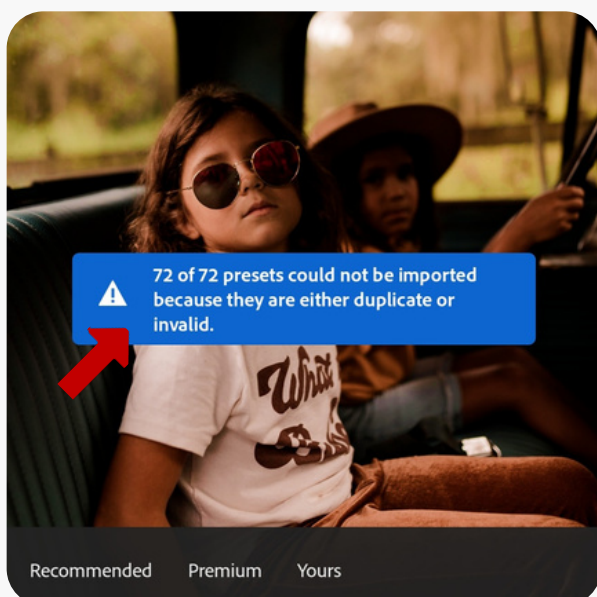
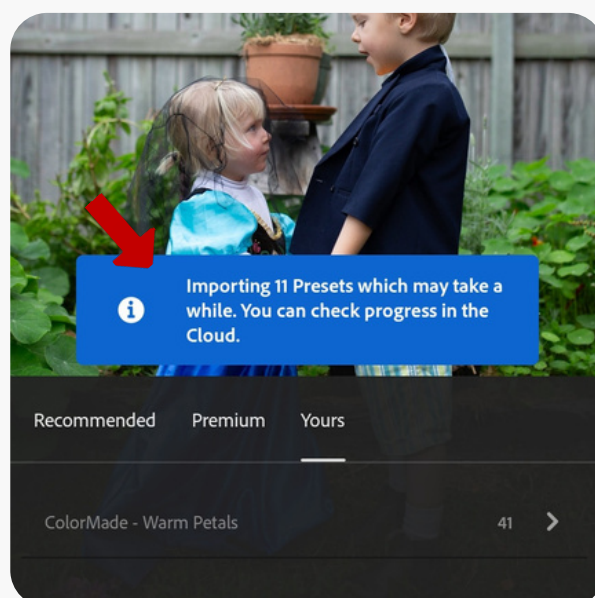

* 13

COULD NOT IMPORT

If you receive a "duplicate or invalid" error it's likely that you downloaded the wrong file type, you already installed the presets, you downloaded multiple copies, OR you interacted with the download prior to LR import.

13

LOCATE PRESETS

If you just installed your presets, you are likely already in the right place. Just be sure you are looking under the "Yours" section to view your newly installed presets!

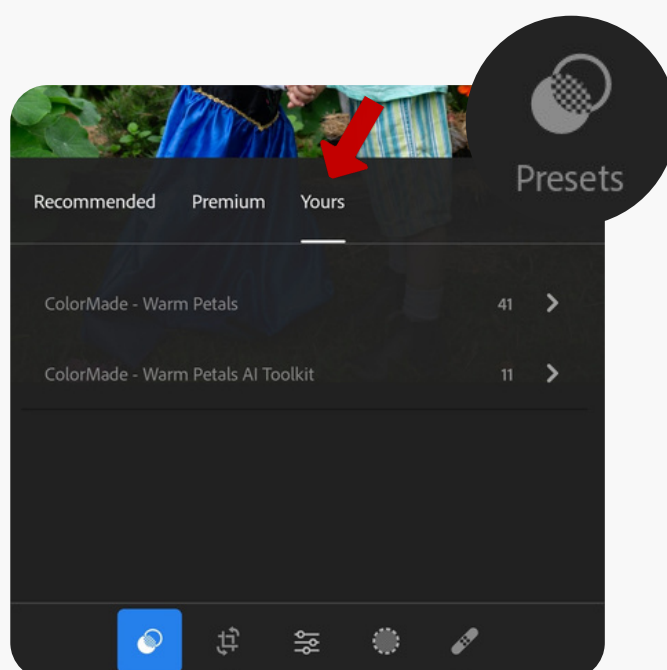

2

USE YOUR PRESETS

1 APPLY PRESET

Under your new preset group, you will see the presets you imported! Click each one to preview. Click the checkmark on the top right to apply!

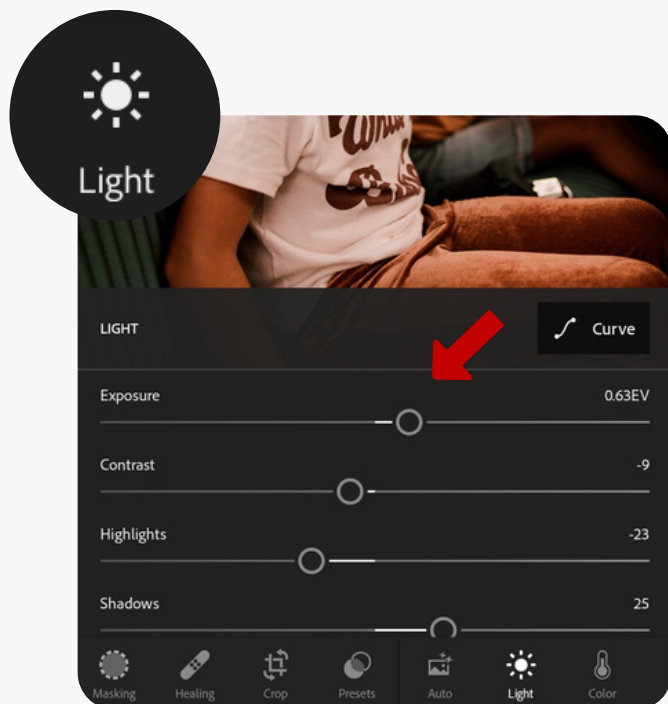
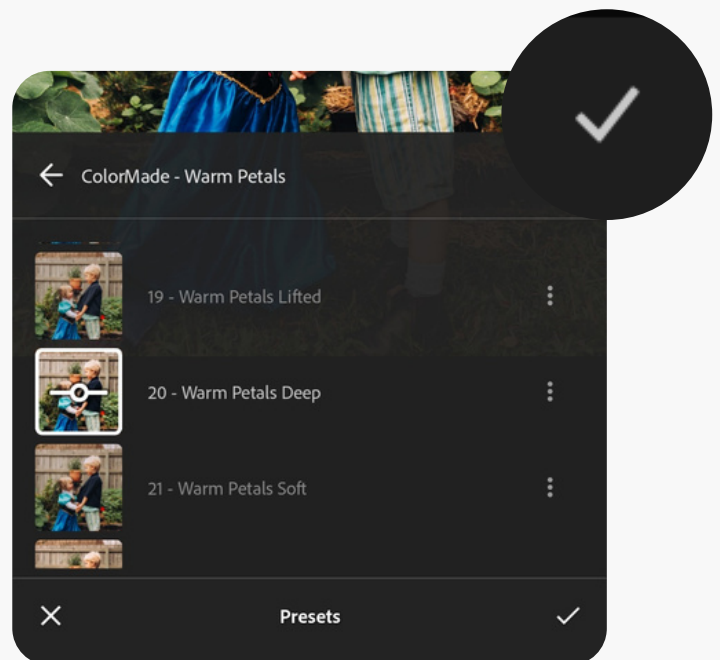

EXPOSURE

If your image is too dark, you can increase brightness by pulling the "Exposure" slider to the right under "Light". You can also decrease exposure if your image is too bright or for a moodier look!

LEARN MORE



WHITE BALANCE

If your image appears too yellow or blue, you may want to correct your **White Balance** under "Color". For quick results, set it to "auto" via the dropdown or place the dropper tool over a neutral in your image.

LEARN MORE

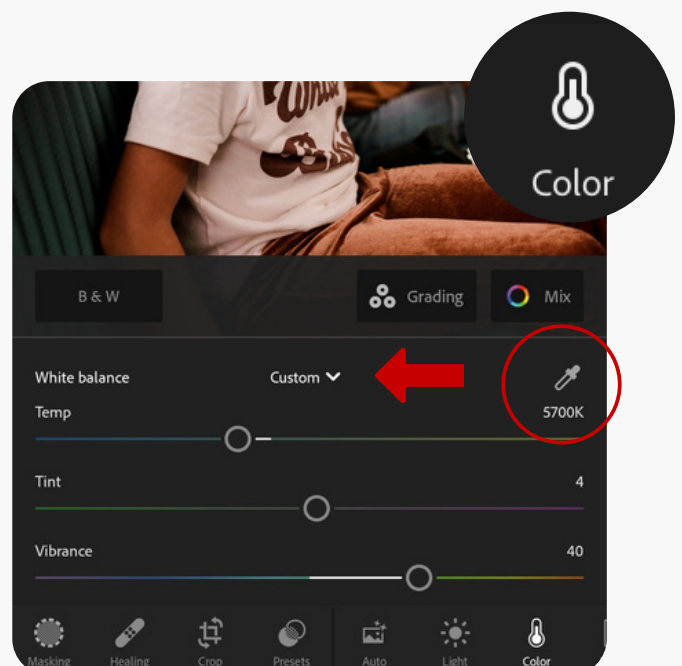



TOOL & LAYER PRESETS

Tool & Layer presets make single setting or stylistic changes on top of your edit. You can stack them by clicking check after each one you apply!

LEARN MORE

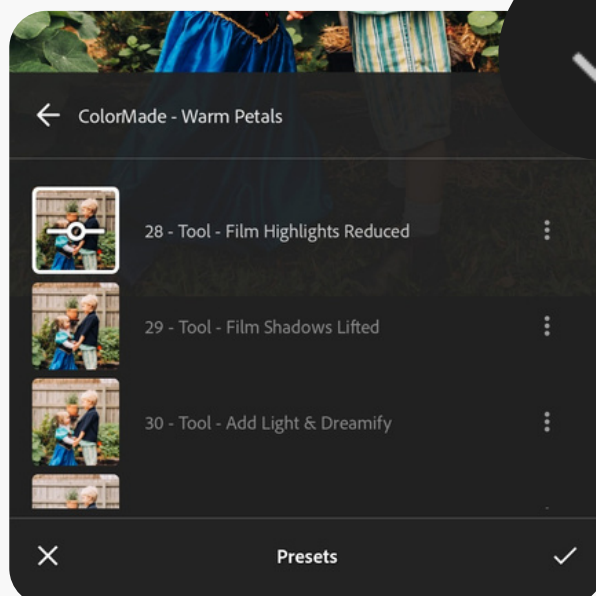

SPECIAL EFFECTS PRESETS

Special Effects Presets will apply AI masking to your image. Special Effects Presets require the premium version of Lightroom Mobile to function!

LEARN MORE

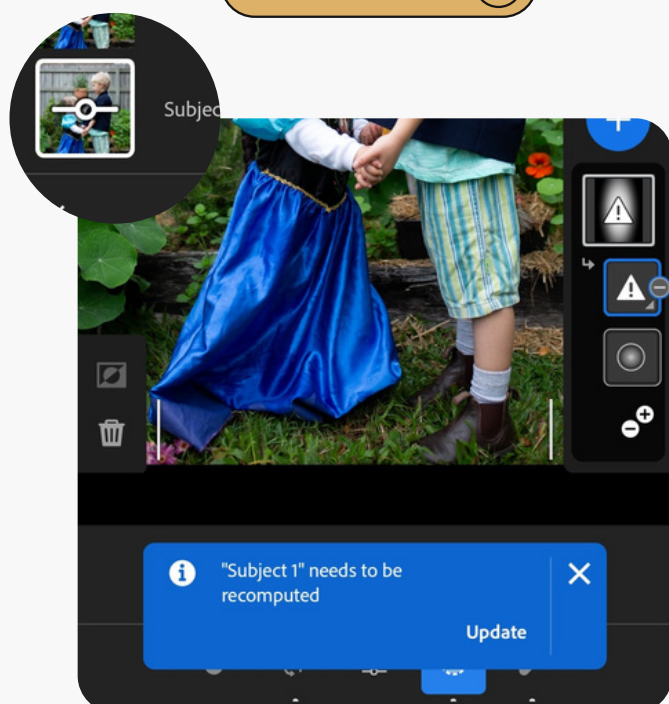

Note: If you purchased a collection with a special AI or Adaptive preset toolkit, always be sure to check out the full guide linked from the collection's product page on our site

3

TROUBLESHOOTING

* CAN'T OPEN FILE?

If you click "Open" on a download pop-up or if you click on your download from your browser's Downloads list you will get a "Can't Open File" Error.

Try your download again & **DO NOT** click on or open the finished download or notifications!

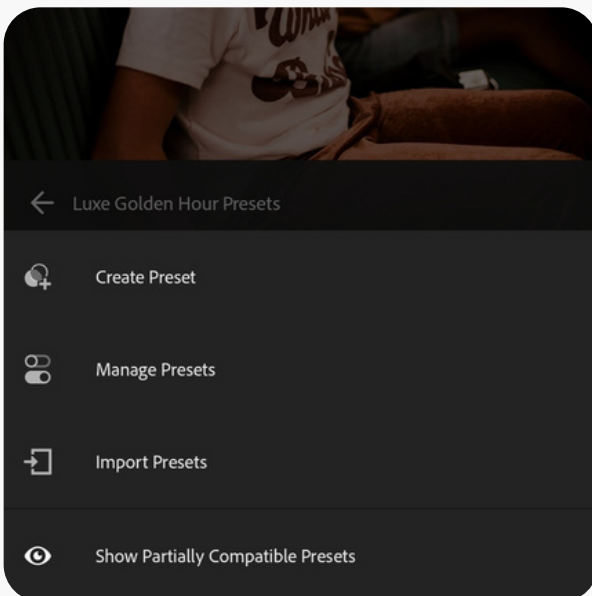
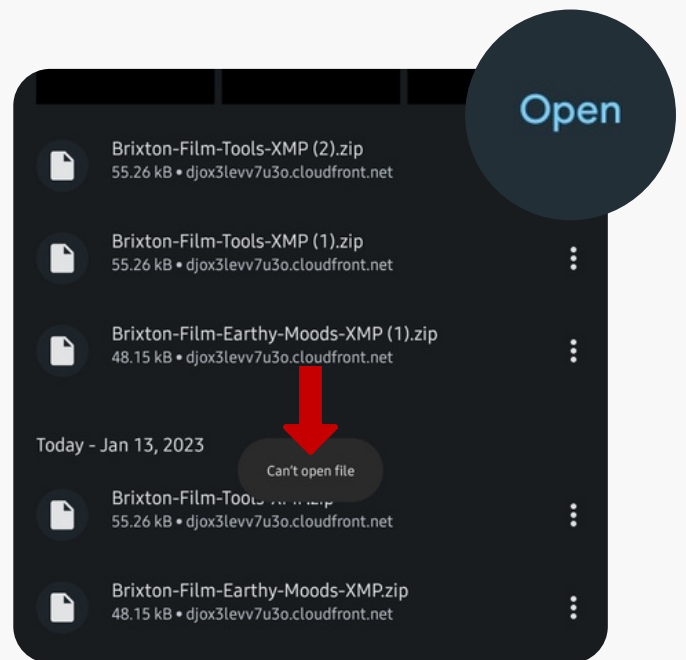

* CAN'T UNZIP?

If you immediately went to unzip your download after install & ran into trouble, don't worry!

Lightroom for Android is designed to import presets as whole .zip files.

* DOWNLOAD LIMIT REACHED?

If you reach this screen please email our support team at Support@theluxelens.com to reset your downloads!

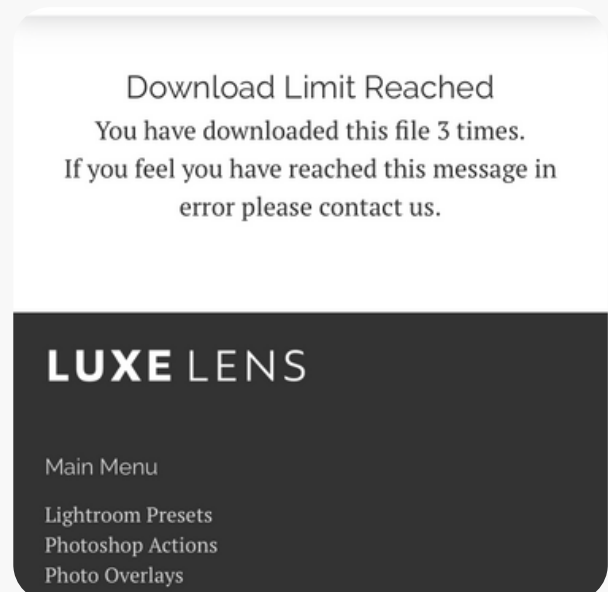

GOT STUCK?

REACH OUT FOR 1:1 SUPPORT AT
SUPPORT@THELUXELENDS.COM